

SCIENCE CAN

©2025 TOPBRIGHT

ELECTRIC GUITAR

Guitare Électrique / Guitarra Eléctrica



↑
HOW TO PLAY?



VN: 1602812024ig0001

TOPBRIGHT ANIMATION CORPORATION TEL: +86 0571 86879395 Address: 6/F, The Agriculture building, Anyang district, Ruian, Zhejiang, China
TOPBRIGHT GmbH Brunnengasse 65, 90402 Nürnberg, Germany E-mail: contact@topbrighttoys.com
Website: <http://www.topbrighttoys.com> Manufacturer: Zhejiang Topbright Toys Co., Ltd.
Address: No.2, Yangfan Road, Bailongshan Street, Yunhe County, Lishui City, Zhejiang Province, China
Sea&Mew Accounting Ltd Electric Avenue Vision 25, London, Enfield EN3 7GD©2025 TOPBRIGHT ANIMATION all rights reserved. MADE IN CHINA

8+
years | **STEAM**
EDUCATIONAL PRODUCT

CONTENTS

ACCESSORY LIST	P.01
PRODUCT ASSEMBLY INSTRUCTIONS	P.02
BATTERY INSTALLATION	P.11
PRODUCT GUIDE	P.13
PLAY INSTRUCTIONS	P.13



HOW TO PLAY?

ACCESSORY LIST

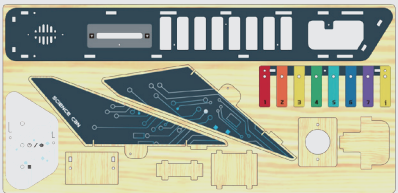

Wooden board 1

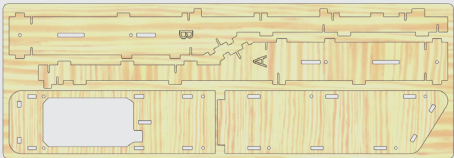

Wooden board 2

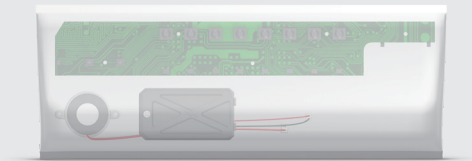

Electronic Accessories Kit

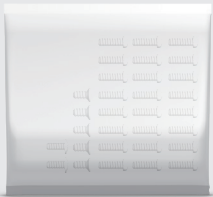

Screw kit

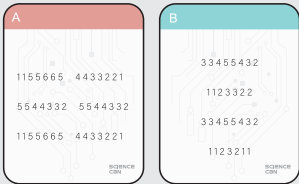

Front Back
Music card

! WARNING!

Any packaging material,including adhesive tapes, plastic pieces, binding wires, tags, etc, is not a part of the product and is not safe for children to play with. For the safety of your children,please dispose the above packaging materials properly. The user manual contains important information, please keep it for later use.

PRODUCT ASSEMBLY INSTRUCTIONS

Before assembling the product, carefully remove the accessories from the wooden board.



Wooden board



Electronic board



5mm screws x5

Step 1:

Align the holes of the electronic board with the holes on the back of the wooden board, then tighten the screws.

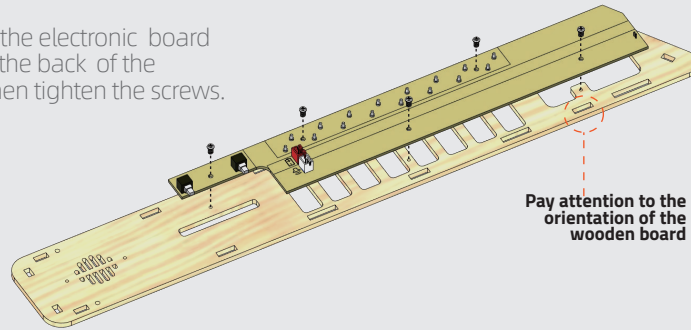

Pay attention to the orientation of the wooden board



Speaker



Wooden board



6mm screws x2

Step 2:

Insert the speaker port into the white port on the electronic board.

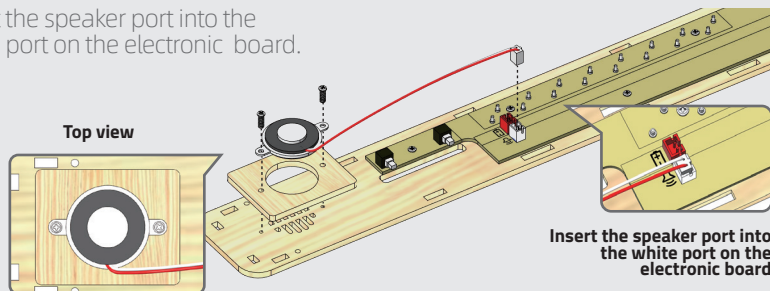

Top view

Insert the speaker port into the white port on the electronic board



Wooden board A



Wooden board B

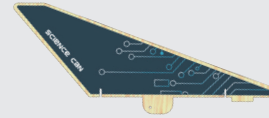

Wooden piece 1

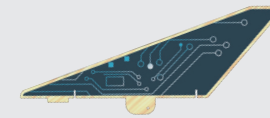

Wooden piece 2



8mm screws x4

Step 3:

Secure the wooden board to the side panels, ensuring that the A and B sides of the wooden board are facing the correct direction.

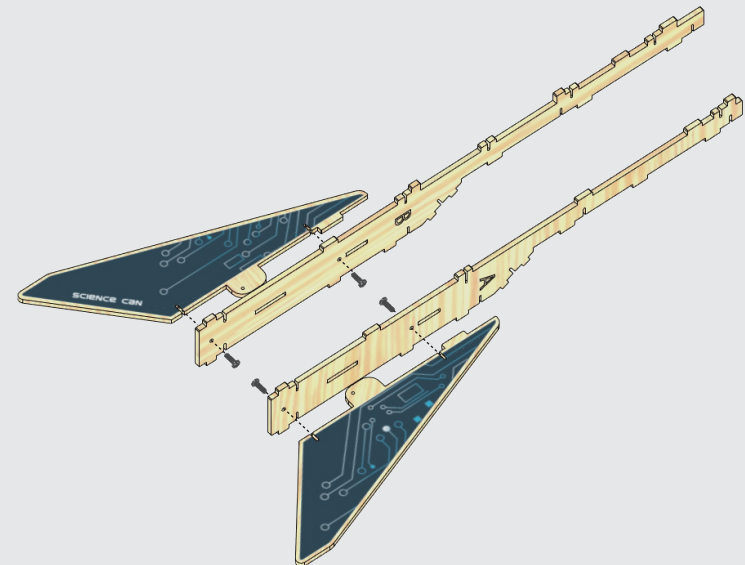

PRODUCT ASSEMBLY INSTRUCTIONS

Step 4:

Fix the side panels to the front panel, ensuring the correct orientation of the A and B sides.

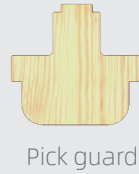
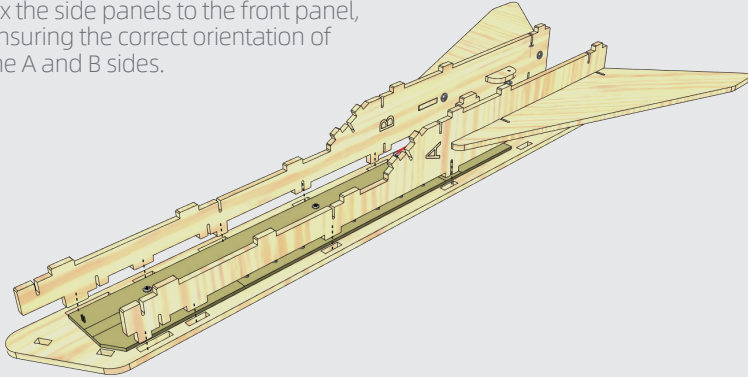

Pick guard

Step 5:

Insert the pick guard into the hole.

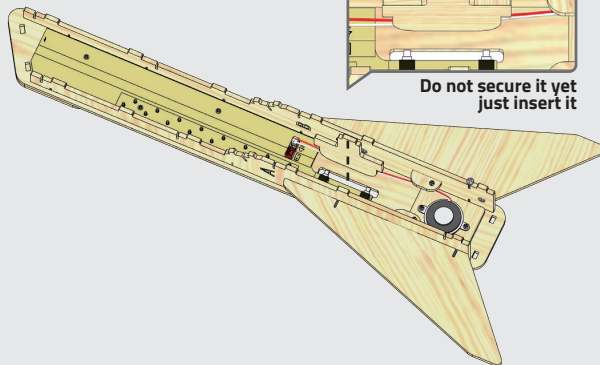

Do not secure it yet just insert it

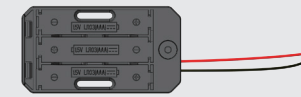

Battery compartment



8mm screws x2

Step 6:

Secure the battery compartment to the side wooden panel.

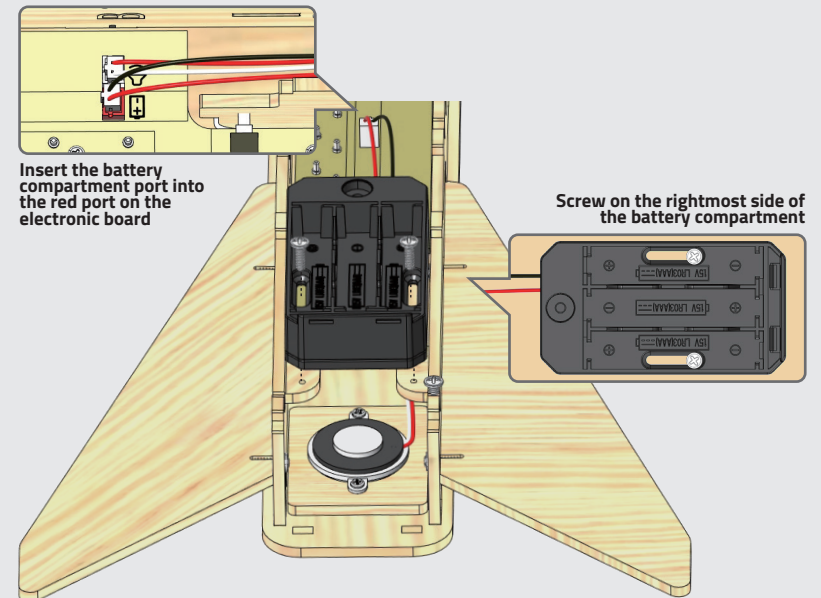

Insert the battery compartment port into the red port on the electronic board

Screw on the rightmost side of the battery compartment

PRODUCT ASSEMBLY INSTRUCTIONS

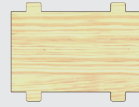

Wooden piece 1



Wooden piece 2

Step 7:

Insert the wooden piece into the slot.

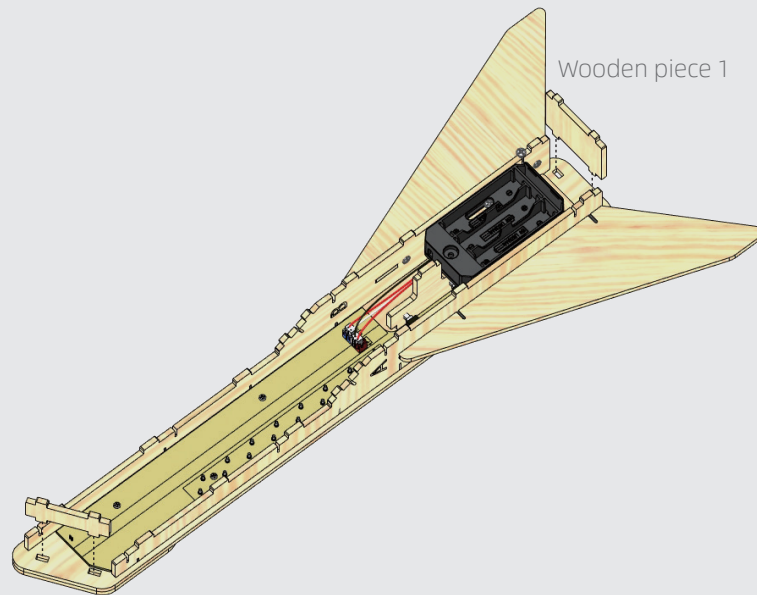

Wooden piece 2



Wooden board back



Wooden board front



8mm screws x8

Step 8:

Insert the wooden piece into the slot, then tighten the screws.

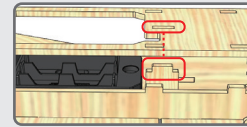

Note: The pick guard must also be inserted into the hole of the wooden piece.

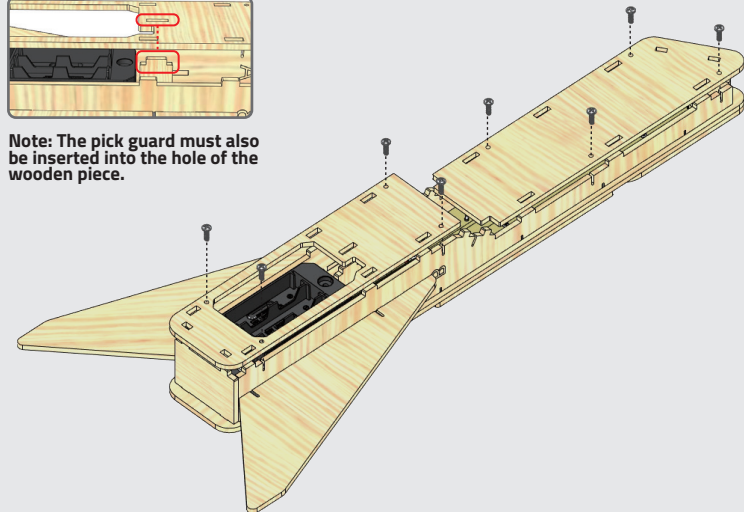

PRODUCT ASSEMBLY INSTRUCTIONS



Wooden piece



8mm screws x2

Step 9:

Insert the wooden piece into the slot, then tighten the screws.

Wooden piece

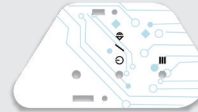
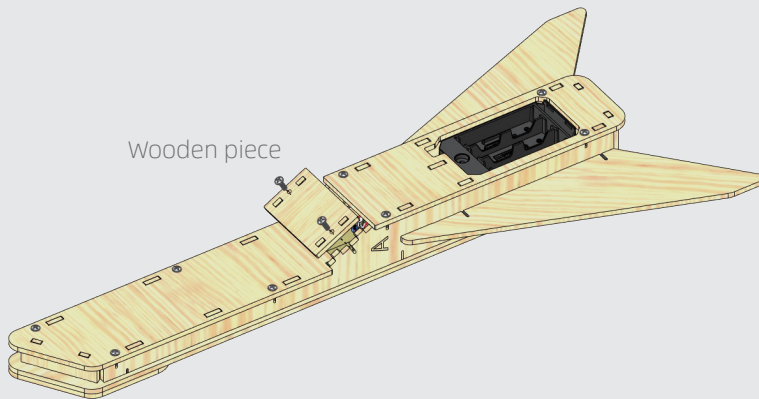

Wooden piece 1

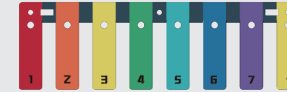

Wooden piece 2



8mm screws x8

Step 10:

Insert the front side of the wooden piece into the slot, then tighten the screws.

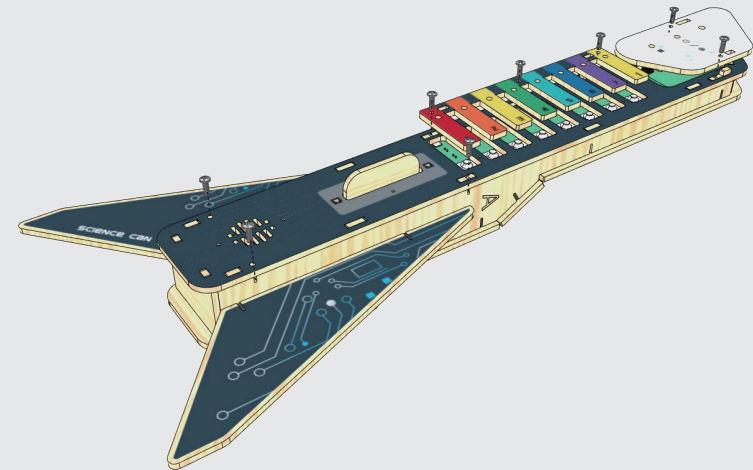

PRODUCT ASSEMBLY INSTRUCTIONS



Battery cover

Step 11:

Tighten the screws after covering the battery cover.

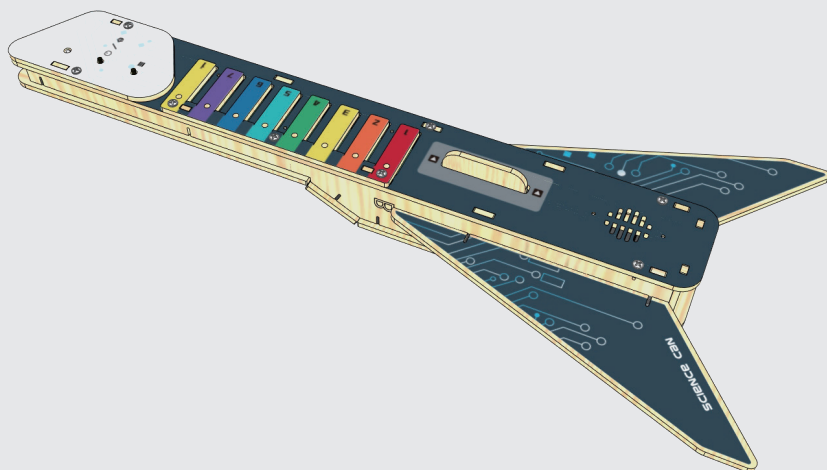
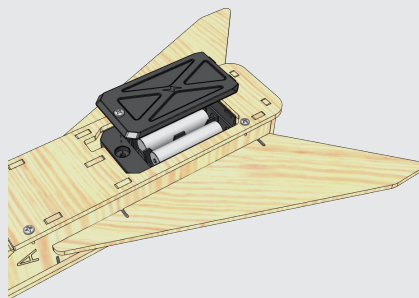

Assembly complete

BATTERY INSTALLATION

1. Flip the product and ensure that the power is turned off.

2. Insert 3 new 1.5V AAA (LR03/7) batteries with the correct polarity (+, -) as shown in the diagram below.

3. Tighten the screws on the battery cover.

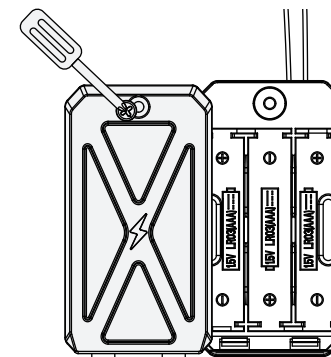

Notes on battery use:

1. An alkaline or carbon zinc battery, etc.can be used.
2. A non-rechargeable battery shall not be charged.
3. A rechargeable battery shall only be charged in the custody of an adult.
4. A rechargeable battery shall be removed from the toy before charging.
5. Different types of battery or used and new batteries shall not be mixed.
6. The batteries shall be installed with the correct polarity (+-).
7. Exhausted batteries shall be removed from the toy.
8. The power terminals shall not be short-circuit-ed.
9. Please remove the batteries if the toy is to be left unused for a long time.
10. Do not throw the battery into the fire.

BATTERY INSTALLATION

Maintenance:

1. Wipe the toy housing gently with a piece of soft, dry cloth to keep the frame clean.
2. Keep the main unit away from sunlight and any other heat source.
3. Please remove the batteries if the toy is to be left unused for a long time.
4. Do not touch the main unit with any hard object or try to disassemble it.
5. Do not put the main unit in water; please keep it from moisture.

Common Troubles and Troubleshooting:

If the toy stops responding for some reason, please:

1. Shut down the main unit.
2. Remove the batteries and cut off power supply.
3. Keep the main unit motionless for a few minutes, and then install the batteries again.
4. Restart the main unit and use it.
5. Please install new batteries if the main unit still doesn't work.

PRODUCT GUIDE

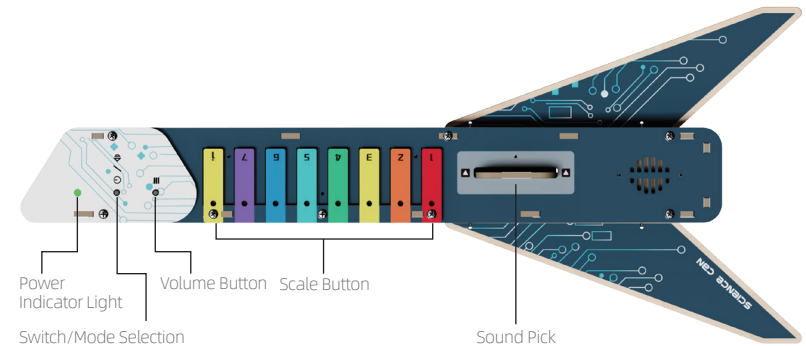

PLAY INSTRUCTIONS

1. Press the switch to turn the device on, the on/off indicator will light up. Press and hold the switch for 2 seconds to switch the instrument off.

When switched on, press the on/off switch again to select the volume between low, medium and high.

2. Press the scale key (a light on the respective key lights up) while you strike the guitar pick to produce the corresponding tone.

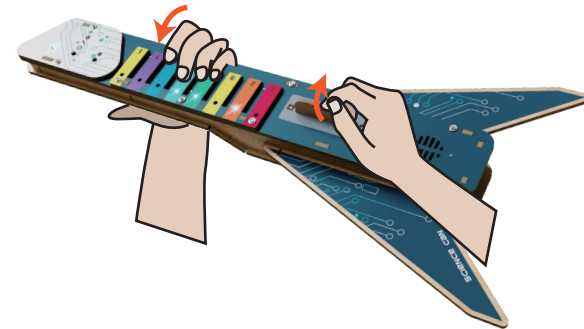

PLAY INSTRUCTIONS

3. Long press the mode button to switch between the three modes:

- (1) Music mode: in this mode, short press the mode button to switch between 5 different instrument sounds: guitar, piano, bass, violin and music box.
- (2) Practice mode: Follow the indicator lights on the keys to practice playing a complete song. In this mode, press the mode switch to select a song (you can choose from 20 songs in total).
- (3) Accompaniment mode: Plays a song automatically. In this mode, press the mode switch to select a song (you can choose from a total of 10 songs).

Song list practice mode

- | | |
|---------------------------------|------------------------------|
| 1. Twinkle, Twinkle Little Star | 11. Summer |
| 2. Ode to Joy | 12. Fairy Tale |
| 3. Pulling The Radish | 13. Blue and White Porcelain |
| 4. Little Bugs Fly | 14. Dreamer |
| 5. The Painter | 15. Little Bliss |
| 6. Happy Birthday | 16. The Wind Rises |
| 7. Jingle Bells | 17. Mercury Records |
| 8. Spirited Away | 18. Floral Sea |
| 9. The Sound of Music | 19. Foam |
| 10. Farewell | 20. Sunny Day |

Song list Accompaniment mode

- | | |
|---------------------------------|----------------------------|
| 1. Twinkle, Twinkle Little Star | 6. The Havanese Dog |
| 2. Ode to Joy | 7. Jingle Bells |
| 3. Pulling The Radish | 8. Oh! Susanna |
| 4. Doll and Bear Dancing | 9. The Sound of Music |
| 5. The Painter | 10. Mary Had a Little Lamb |